

BOAT SHUTTLE BOBBIN WINDER WOODEN

Before commencing

Read the instructions completely, identify the parts and note the assembly sequence. Use the fine sandpaper supplied to remove any sharp corners or edges.

Finishing the wood

We recommend using Ashford Finishing Wax Polish on the timber surfaces before assembly, this protects it from climatic changes and enhances the beauty of the timber.



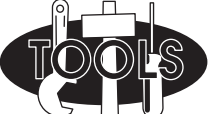





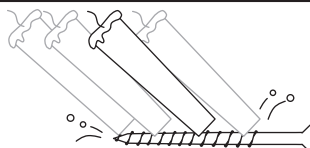

To make assembly easier rub candle wax on the screws.

Assembly

1. Attach the base to the upright with 2 x 45mm (1¾") screws.
2. With the handle to the outside place the wheel onto the shaft and push the dome cap on.
3. Place the drive band around the wheel and spindle pulley. **NOTE:** Remove the drive band when not in use to avoid it stretching.
4. Apply a drop of oil occasionally to the tapered shaft bearings. **NOTE:** The wheel is fitted with a ball bearing and doesn't need oiling.
5. Assemble the clamp as illustrated.
6. Clamp your boat shuttle bobbin winder to a bench or table.
7. Slide a bobbin onto the tapered shaft until tight.
8. Wind your yarn onto the bobbin.

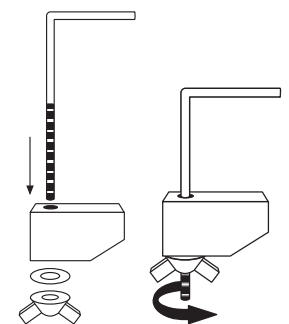

Clamps

Happy Weaving!

Other Ashford weaving accessories:

Boat shuttle bobbins are available in packs of 10 - Standard or XL size
 Boat shuttle 29cm (11½") includes 1 bobbin
 XL Boat shuttle 38cm (15") includes 1 XL bobbin

BSBWW091025