

WARPING MILL

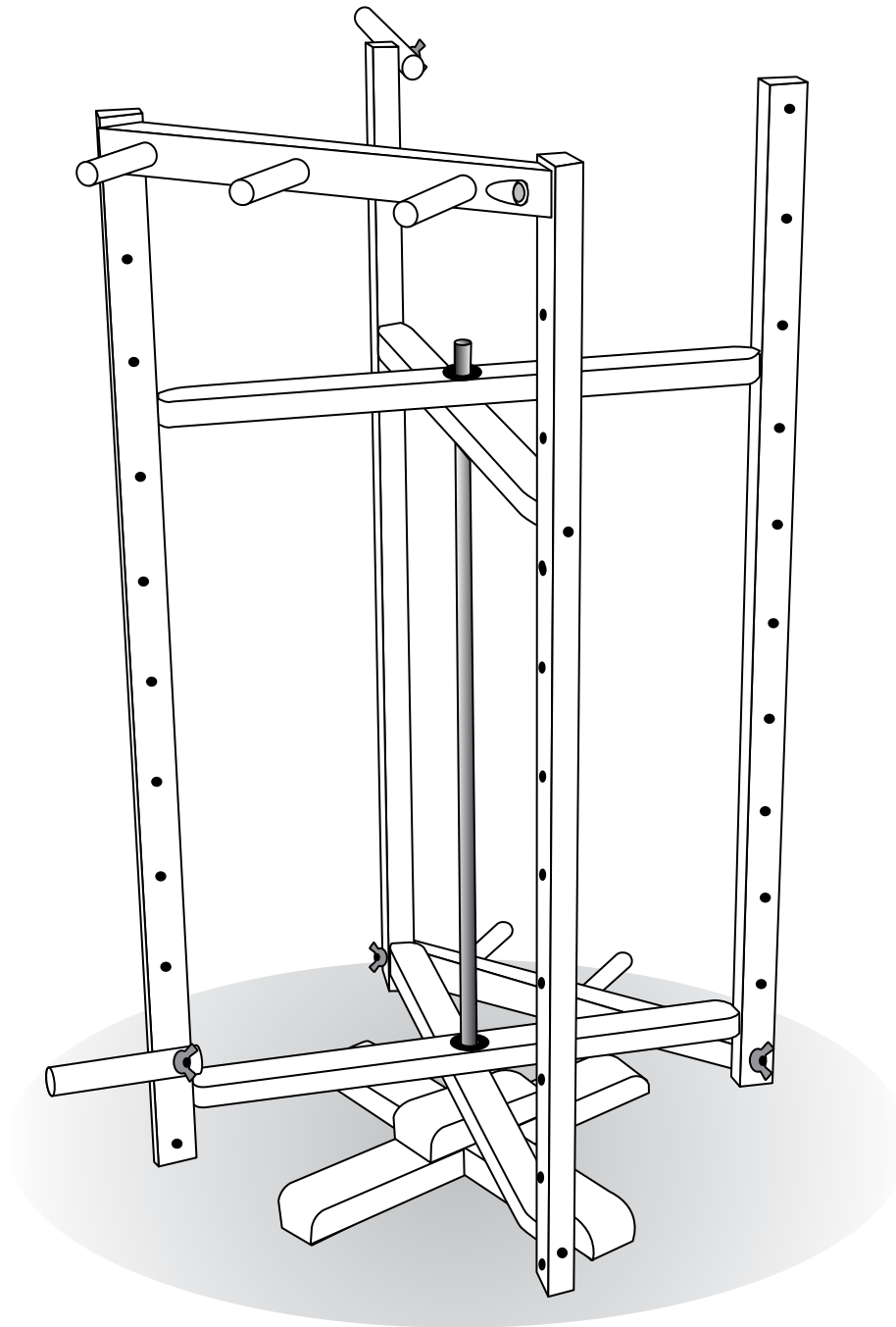

WM09022012V3

Parts List

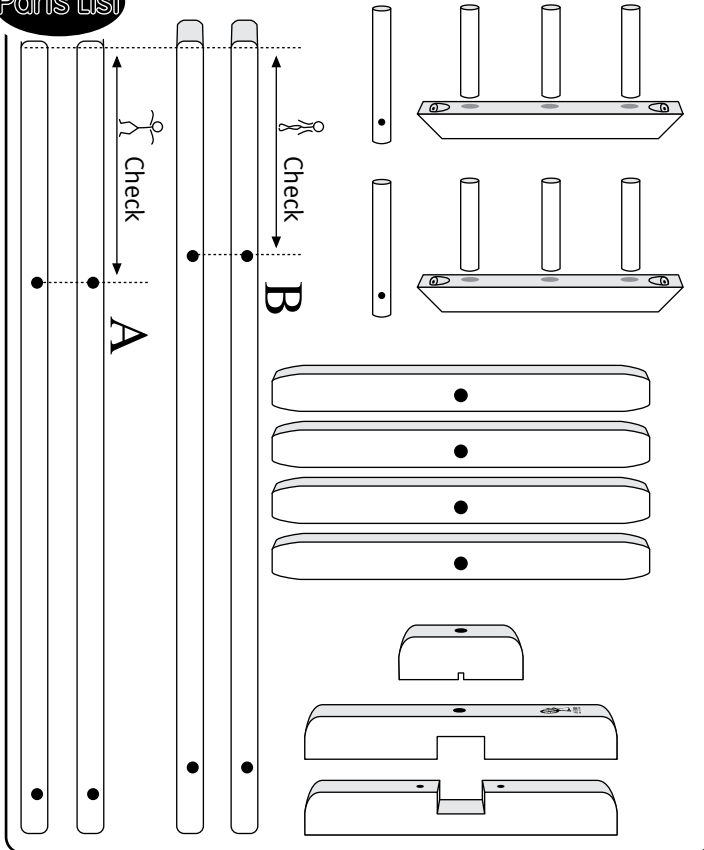

TOOLS

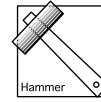

Hint

To make assembly easier use candle wax on the screws.

Hard

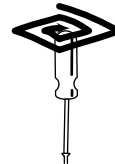

Easy



Hardware List



X4



X6



X6



X10

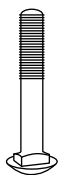

X4

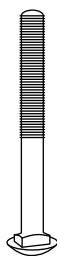

X2

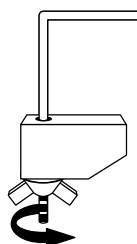
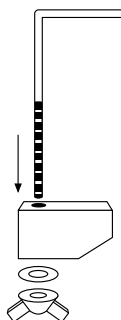

X2

Before Commencing

Read the instructions completely, identify the parts and note the assembly sequence. Then use the fine sandpaper supplied to remove any sharp corners or edges.

Finishing the Wood

We recommend that the wood surfaces be waxed before assembly. This protects the kiln dried wood from climatic changes and enhances the beauty of the wood. Avoid waxing the dowel ends or holes.

For the Ultimate Finish

The Ashford Wax Finish will enhance the natural colours and beauty of the native New Zealand Silver Beech timber which has a lovely variety of colour and grain.

Step 1

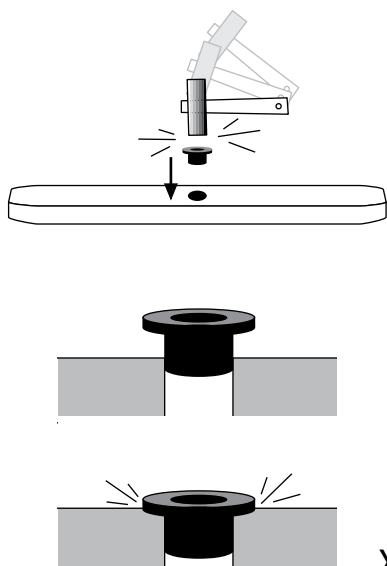

X4

Step 2

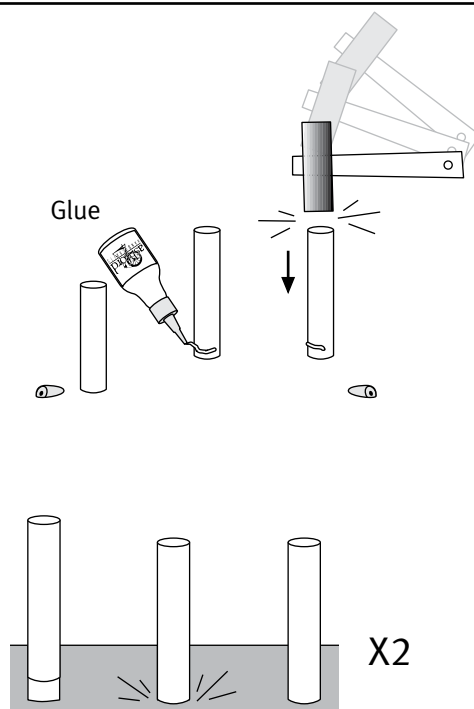

X2

Step 3

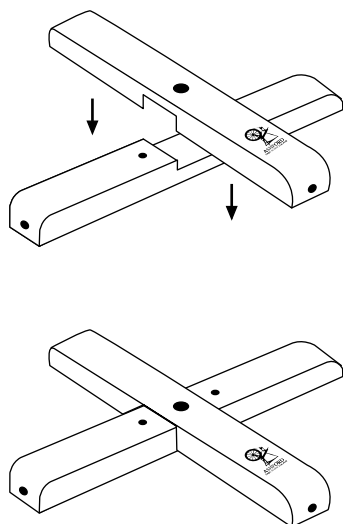

Step 4

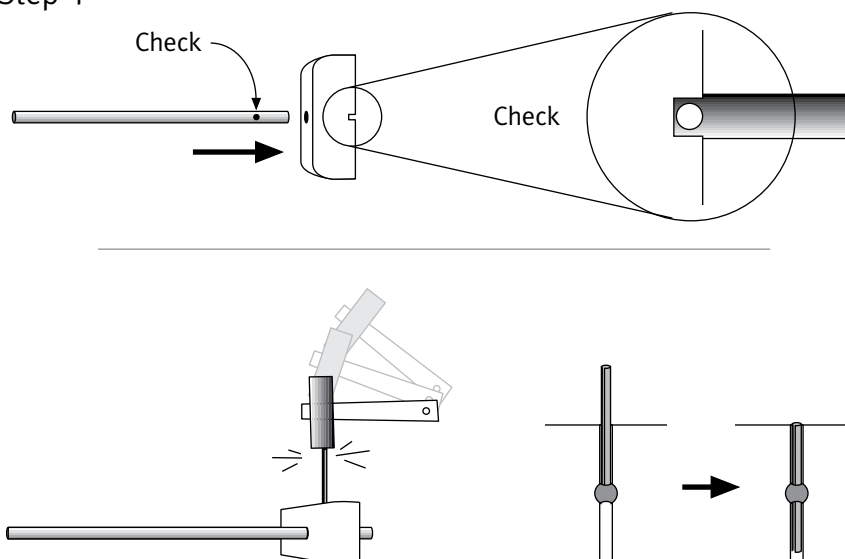

Step 5

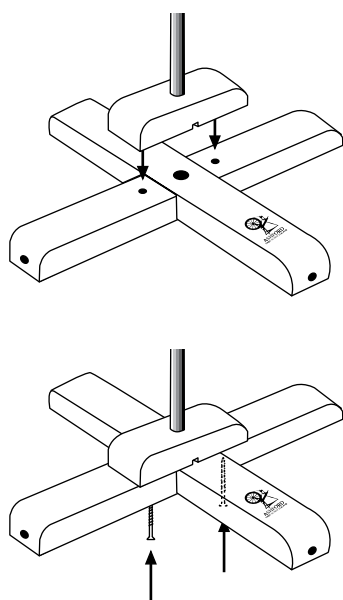

Step 6

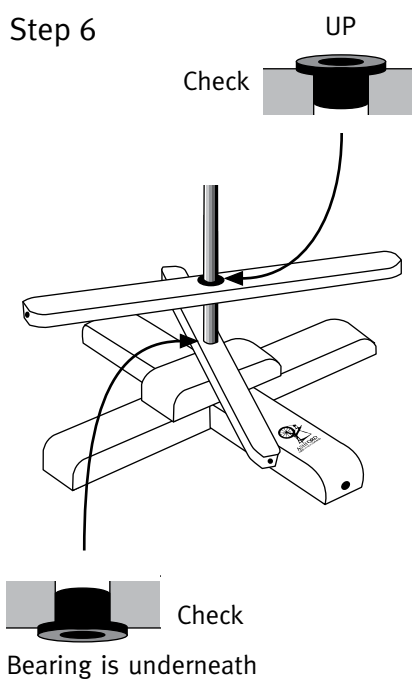

Step 7

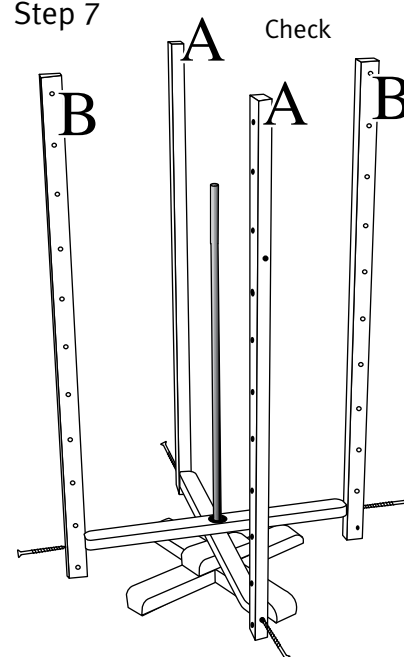

Step 8

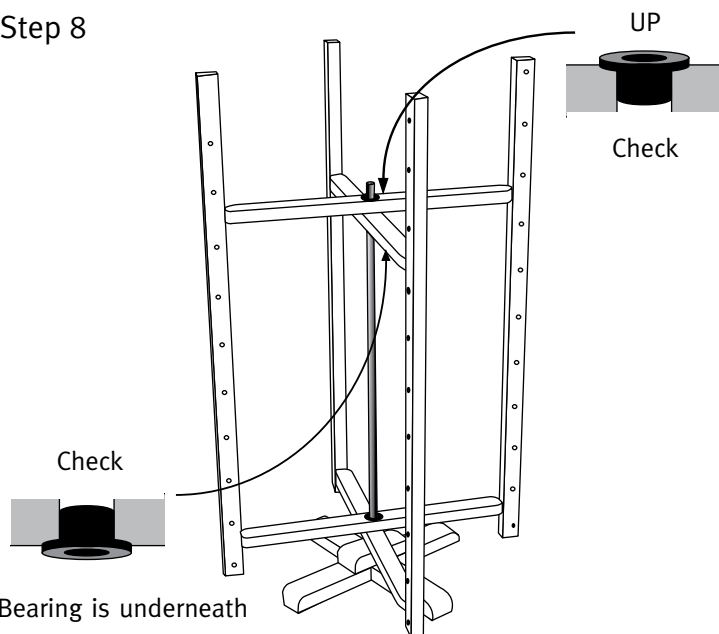

Step 9

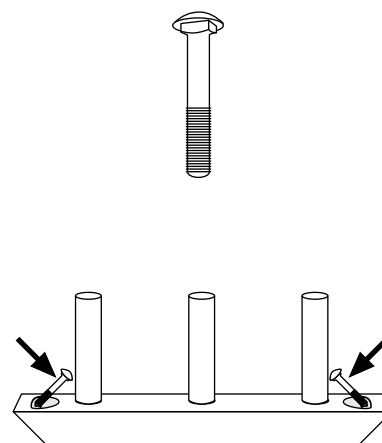

Step 10

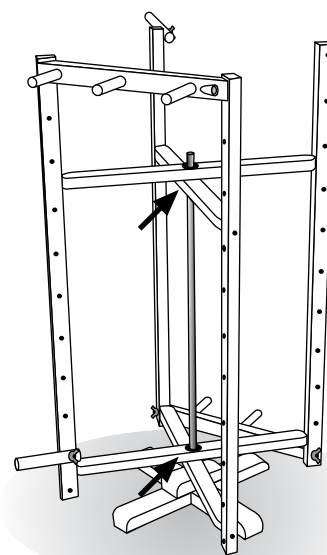
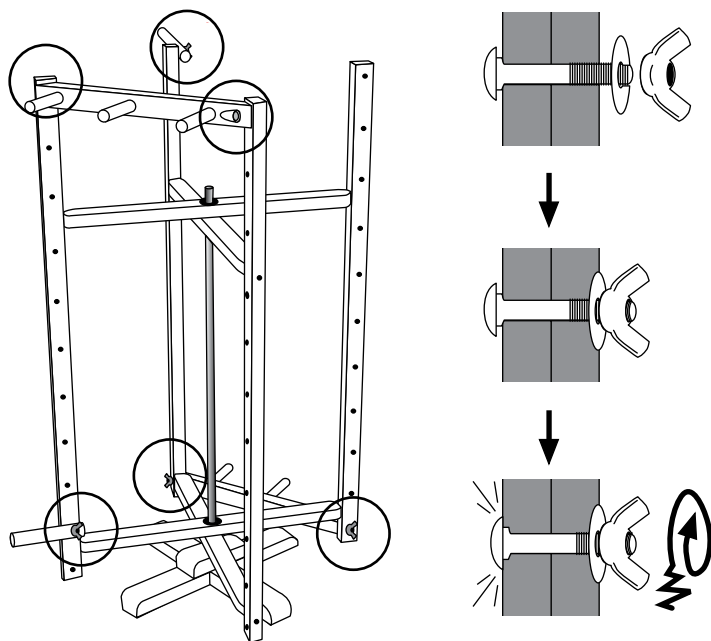

*Optional accessory Ashford Spinning Wheel Oil

